

# LOKTHOR

## JTC4250



The Force of Thunder in Hand

## Safety Instructions

**Please read the following instructions carefully before using your new Lokithor multi-function vehicle jump starter (hereinafter referred to as Lokithor):**

1. Please follow all instructions in this manual for safe Lokithor operation. Failure to follow all instructions in this manual or improper use of Lokithor products may result in property damage and or personal injury
2. Lokithor is designed for starting 12V engines and is not designed for starting vehicles exceeding product specifications in system voltage or engine displacement.
3. Warning when using FORCED START mode all Lokithor safety features are disabled.
4. Do not allow the clamps to short together or touch when using FORCED START mode. Please read and understand all safety procedures before using Forced Start mode.
5. For best longevity of your Lokithor product we recommend a quarterly maintenance program. Please fully charge your new Lokithor product upon receipt. We recommend checking the charge level every 3 months and recharging if necessary. Also you may use the power bank feature and or the flashlight during this time to discharge the battery to approximately 50% and then recharge Lokithor to full before placing it back in your vehicle. This good practice will help ensure you get the best product lifespan and that Lokithor is always ready for the next emergency.
6. Do not use a damaged Lokithor. If your device has had impact damage, has been hit, dropped or exposed to other physical damage do not use it. Using a damaged Lokithor may cause a dangerous situation.
7. Do not attempt to use Lokithor while it is charging.
8. Please do not disassemble Lokithor. There are no user serviceable parts inside.
9. Use extra caution when working with vehicle batteries and Jumpstarters. Do not drop metal objects on battery terminals while using Lokithor. Any metal object can cause a short, leading to a dangerous situation that may result in equipment damage and or explosion.
10. When starting a vehicle, ensure that the positive and negative cable clamps have a good solid connection to the battery terminals.
11. Do not allow sparks and or flames to contact Lokithor or the vehicle engine. Always connect your Lokithor to the vehicle battery before attempting to power it on or Jumpstart a vehicle
12. To prevent short-circuit and sparks from damaging the jump starter DO NOT connect the positive and negative cable clamps together and DO NOT connect clamps to the same piece of metal(short circuit).
13. Lokithor is not intended for use by children. Do not leave the jump starter in a place where children can easily reach it.
14. Do not expose Lokithor to rain or snow.
15. Do not leave the Lokithor in extreme environments for long periods of time (extreme heat above:>131°F(55°C),or extreme cold below:<14F(-10°C),humidity;>80% humidity).
16. When not using Lokithor please store it in a cool dry place.
17. Please ensure a good maintenance program for your Lokithor: Charge it in a timely fashion after being used, or when it is in a discharged condition. Failure to do so may cause an over-discharge condition leading to low internal battery voltage or an out of power condition. Long periods of time with low or no power may cause permanent product failure.

## Product Overview

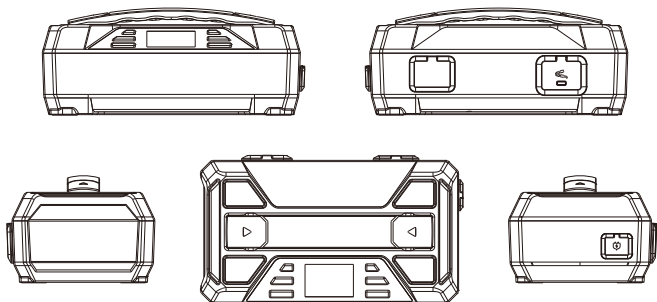

## Specifications

Model:	JTC4250	Battery Charger	
Jump Starter		Input AC:	100-240V ~ 50/60HZ 2A Max
Nominal Voltage:	12.8V	Charging Output:	6V (6A), 12V ~ 15V (6A) Max 90W
Capacity:	7000mAh 89.6Wh (LiFePO4)	Battery Chemistries:	Lead-Acid and LiFePO4
Starting Voltage:	12V	Battery Types:	6V, 12V
Starting Current:	3000A	Supported vehicle battery capacity:	Up to 120Ah
Peak Current:	4250A	Operating Temperature:	-10°C to 45°C (14°F to 113°F)
Charging Temperature:	0°C to 45°C (32°F to 113°F)	Low-Voltage Detection:	1V
Storage Temperature:	-20°C to 50°C (-4°F to 122°F)	IP Rating:	IP65 (w/ Ports closed)
Operation Temperature:	-20°C to 60°C (-4°F to 140°F)	Other	
Service Life:	>2000 cycles (in good condition)	USB - A Output:	5V / 3A, 9V / 2A, 12V / 1.5A
12V Battery Tester		USB - C Input & Output:	5-20V / 3A (PD 60W)
Cranking Test:	Supported	BX80 Output (Under power supply mode):	5-20V 0-6A, 90W Max (AC Power)
Charging Test:	Supported		5-20V 0-5A, 60W Max (Battery Power)
Battery Test:	Supported	LED Lumen:	300 lumens
Bluetooth Connection:	Supported	Dimensions (L x W x H):	264*146.2*109.5mm (10.39*5.76*4.31inch)

## Button and Screen Descriptions

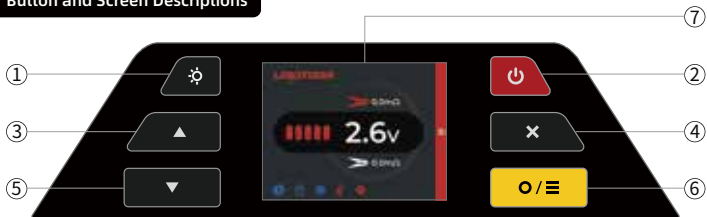

No	Function Description	No	Function Description
1	Light Mode Button	2	Power Button (Press to turn on & off)
3	Up	4	Cancel Button
5	Down	6	Confirm Button
7	Display		

## Input / Output Instructions

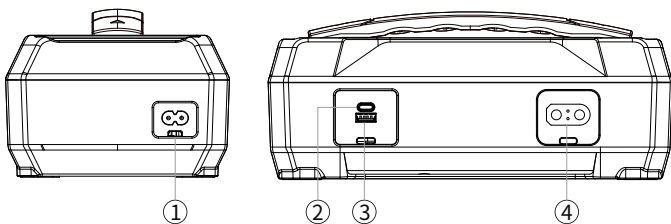

No	Functional Description	No	Functional Description
1	AC input port	2	USB-C input & output port
3	USB-A output port	4	BX80 Jump-start / Battery charge / Battery test output port

## Interface Layout

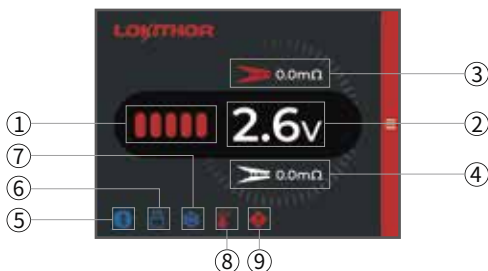

No	Function Description	No	Function Description
1	Battery Indicator	2	Voltage Indicator
3	Positive Clamp Indicator (Green: Good connection Red: Poor connection)	4	Negative Clamp Indicator (Green: Good connection Red: Poor connection)
5	Bluetooth Indicator	6	Type C Indicator
7	Low Temperature Indicator	8	High Temperature Indicator
9	Error Indicator		

## Packing List

Physical Product	Manual	USB - A To USB - C Wire	USB - C TO USB - C Wire
BX80 Clamp (Used for Jump starter & battery charge & battery test)		Power Cable (The plug type varies by country or region)	

### 1. How to Power Up Lokithor

There are four ways to power up the device:

1. Short press the "Light Mode Button" for 1 second
2. Short press the "Power Button" for 1 second
3. When the AC port is connected to the power supply
4. When the TYPE C port is connected to a power supply

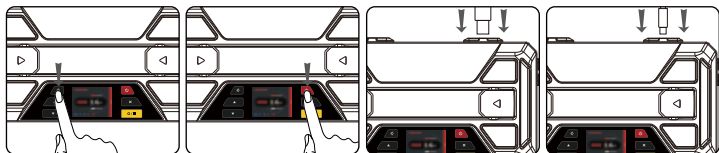

### 2. Using the Jump-Start Function

(When connected to AC power, the Jump-Start function cannot be used.)

#### 2.1 12V Auto Start

- 2.1.1 Short press the "Light light Button" or "Power Button" to power up the device
- 2.1.2 Connect the Jump starter clamp to the BX80 port;
- 2.1.3 Connect the positive and negative clamps to the corresponding terminals on the vehicle battery, ensuring a secure connection;
- 2.1.4 Press the "Confirm" button to enter the mode selection interface, select the jump start mode, then press the "Confirm" button to choose "Normal Jump Start", the screen will display the real-time vehicle battery. You can press "Confirm" again to enter the jump starter state to start the vehicle;
- 2.1.5 If the vehicle starts successfully, short press the "confirm button" to exit the start function, and then disconnect the clamps.

In most cases, the vehicle will be able to start immediately after the jump starter has been connected. If the vehicle does not start immediately, please check the contact position of the jump clamps and retry. Do not attempt more than five times within 15 minutes.

Please remove the jump-start clamps from the vehicle battery immediately after you finish starting. Press the "Power button" for 2 seconds to shut down the jump starter. If there are no operations for 60 seconds, the product will automatically shut down;

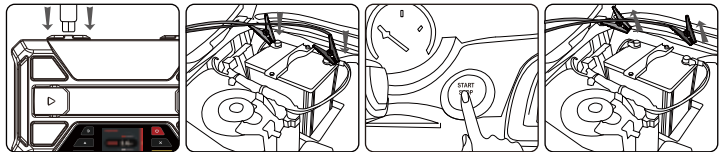

#### 2.2 Forced Start

(Safety Reminder: In this mode, the anti-spark function and some safety protection mechanisms are disabled. Please use with caution and avoid reversing the positive and negative terminals, as this can cause a short circuit accident. Always review the operating instructions before use.)

When the 12V auto start function fails, you can use the forced start function by referring to the operational guidelines in the manual. Please strictly follow the steps below to use the forced start; otherwise, this function may not work properly.

- Step 1: Short press the "LED Light Button" or the "Power Button" to power up the device.
- Step 2: Insert the clamp into the BX80 port of the product.
- Step 3: First, connect the positive terminal of the clamp to the positive terminal of the vehicle battery.
- Step 4: Press the "Confirm" button to enter the mode selection interface, and select the start mode. Then press the "Confirm" button again, choose the "Forced Start" mode, and press the "Confirm" button to enter the forced start mode. Ensure that the positive and negative terminals are not short-circuited during this step.
- Step 5: Connect the negative terminal of the clamp to the negative terminal of the vehicle battery and ensure a good connection. At this point, the screen will display the voltage of the LOKITHOR in parallel with the vehicle battery, allowing you to proceed with the car start operation. Short press the "Cancel button" to exit.

## 2.3 Battery Clamps Connection Status Display (ConnectMax)

When the clamp is connected to the vehicle battery, the display will show the internal resistance value between the clamp and the vehicle battery. If the internal resistance result is displayed in green, it indicates a good connection. If the internal resistance result is displayed in red, it indicates a poor connection. Please readjust the connection between the clamp and the vehicle battery.

## 3. How to use the battery-charge function

This mode allows charging, reconditioning, and DC voltage output for different types of vehicle batteries.

### 3.1 Standard Charging Mode

Connect the AC charging cable to Lokithor, and power up the product, select "Charging Mode", enter "Standard Charging mode", and choose one of five battery types: "12V Regular, 12V AGM, 12V Lithium Iron, 6V Regular, 6V AGM". After confirming the battery type, set the charging current, then press the "Confirm button" to enter Standard charging mode.

This mode only charges batteries with a voltage above 1V. If the battery voltage is below 1V, use the "Forced Charging mode".

### 3.2 Forced Charging Mode

**(Safety Reminder: In this mode, the anti-spark function and some safety protection mechanisms are disabled. Please use with caution and avoid reversing the positive and negative terminals, as this can cause a short circuit accident. Always review the operating instructions before use.)**

Connect the AC charging cable to the product, wake up the product, press the "Confirm button" to enter the mode selection interface, choose "Charging Mode", then select "Forced Charging mode" to enter forced charging mode. This mode only charges batteries with a voltage below 1V and will automatically exit after 5 minutes. If the battery voltage is above 1V, use the "Standard Charging mode".

### 3.3 Maintenance Mode

Connect the AC charging cable to the product, wake up the product, press the "Confirm button" to enter the mode selection interface, choose "Charging Mode", then select "Maintenance Mode" to enter the Maintenance mode. In repair mode, the product first charges the battery, then performs a continuous 4-hour PULS Maintenance after full charge. This mode only maintains batteries with a voltage above 1V. If the battery voltage is below 1V, please use 'Forced Charging' to charge the battery.

### 3.4 Power Supply Mode

**(Safety Reminder: In this mode, the anti-spark function and some safety protection mechanisms are disabled. Please use with caution and avoid reversing the positive and negative terminals, as this can cause a short circuit accident. Always review the operating instructions before use.)**

#### Method One (AC mode):

Connect the AC charging cable to the product, power up the product, press the "Confirm" button to enter the mode selection interface, choose "Charging Mode", then select "Digital Power Mode" to enter the power mode.

In this mode, the output voltage can be adjusted from 5V to 20V, current up to 6A (90W MAX).

In this mode, if the AC power suddenly drops, the product will automatically switch to Method Two (DC mode), while the output voltage remains the same as before the AC power drop, with power changing to 60W MAX.

#### Method Two (without AC input, i.e., DC mode):

Short press the "LED Light Button" or "Power Button" to power up the product, press the "Confirm" button to enter the mode selection interface, choose "Charging Mode", then select "Power Mode" to enter the power mode.

In this mode, the output voltage can be adjusted from 5V to 20V, current up to 5A (60W MAX).

## 4. How to use the battery-test function

This mode allows testing the state of vehicle batteries.

### 4.1 Battery Test

Power on Lokithor, press the "Confirm button" to enter the mode selection interface, choose "Battery Test Mode", press the "Confirm button", then enter "Battery Test" mode. First, choose the battery type: "Regular Lead-Acid, AGM Flat Plate, AGM Spiral, GEL, EFB". Then choose the standard: "CCA, DIN, IEC, EN, SAE". Set the parameters (refer to the battery label for details), and press the "Confirm" button to start the battery test.

### 4.2 Cranking Test

Power on Lokithor the product, press the "Confirm button" to enter the mode selection interface, choose "Battery Test Mode", press the "Confirm button", then enter "Cranking Test" mode.

### 4.3 Charging Test

Power on Lokithor, press the "Confirm button" to enter the mode selection interface, choose "Battery Test Mode", press the "Confirm button", then enter "Charging Test" mode.

## 5. How to use LED Function



1. Long press the "LED Light Button" for 1 second to turn on the LED light;
2. Cycle through modes by short pressing the "LED Light Button": 100%/50%/10% steady on, SOS, Strobe, Off; Press and hold the "LED Light Button" for 2 seconds to turn off the LED light;

## 6. How to Charge Lokithor

Tools: Power adapter (PD2.0/PD3.0 protocol power adapter)

USB-C to USB-C cable

USB-A to USB-C cable

AC charging cable

Connect one end of the USB cable to the power adapter and the other end to the product's USB-C charging port. The battery charge indicator will indicate that the product is charging.

Connect the product to the mains using the AC charging cable. The screen's running light will illuminate, indicating normal charging.

If the product has low or no power, charge it promptly to avoid low battery voltage.

Do not leave Lokithor in a discharged condition for extended periods. This may cause a condition that will prevent Lokithor from charging.

## 7. How to connect to the APP via Bluetooth

1. Please scan the QR code below to download the "Bat Test" application.
2. Open the "Bat Test" application, select the device section, and connect the product. Once successfully connected, you can view the diagnostic data. If you need to print the test data, please export the file first.





## 8. Language Settings

You can choose from five languages: Chinese, English, French, German, Spanish.



## 9. Error Codes Display

NO.	ERROR CODE	Illustration	Reason/Solution
1	140	Charging Reminder	Charge Lokithor
2	 150	Over Temperature Protection	Wait for the product to cool down
3	 160	Low Temperature Protection	Use the product in a suitable temperature environment
4	200	Communication Error	Restart the device
5	430	External Battery Voltage Exceeds Device Voltage	① Check if the car battery is a 12V battery ② Charge Lokithor
6	440	Clamps Reversed	Connect the battery correctly
7	450	Jump Start Failure	After confirming the correct connection, please refer to the manual to use the forced start.
8	320	Overload Protection/ Short Circuit Protection	Check the load connection to ensure it is properly connected and used within the rated power.

### Warnings

#### \* Do not disassemble the product as it contains no user-serviceable parts.

1. Lokithor can start a vehicle when it's battery capacity is over 50%. If the state of charge is too low, Lokithor may not be able to start your vehicle.
2. It is normal for the device to get slightly warm after use.
3. To maximize battery life, charge the device at least once every three months.
4. If you notice leaks or unusual smells, stop using the device and contact us immediately.
5. Do not connect the red clamp to the black clamp. This is a short circuit condition and is dangerous.
6. Use only Lokithor brand jump starter clamps. We can not ensure safety with use of any other device or clamp connected to Lokithor.
7. Do not expose Lokithor to fire or water as this has the potential to create a dangerous situation.
8. Do not expose Lokithor to temperatures above 60°C or leave it in direct sunlight. Store it in a cool, dry place.
9. Do not disassemble or modify Lokithor in any way.
10. Do not drop, or crush Lokithor as this could cause fire and or explosion.
11. Do not use chemicals or solvents to clean Lokithor.
12. This product is not intended for use by children. Keep out of reach of and away from children.

### Recycling Treatment

1. Do not dispose of this product with regular household waste when it reaches the end of its life. This could harm the environment or human health.
2. Keep it separate from other waste and recycle it responsibly to promote sustainable resource use.

### Warranty Policy

#### We offer a limited warranty on the product 12 months from the date of purchase on any defects in materials and workmanship. Conditions are as follows:

1. The buyer must provide proof of purchase (details including date and store on the order page/invoice, etc.)
2. This warranty does not cover damage or malfunction caused by normal wear and tear, physical damage to the product, improper installation, misuse, abuse, modification or unauthorized repairs by third parties.
3. The manufacturer shall not be liable for any loss or damage caused in transit by a third party or by force majeure.
4. The manufacturer is not responsible for any incidental or consequential damages arising from the use or misuse of this product.
5. All warranty claims are limited to the repair or replacement of defective products and are at our sole discretion.
6. If we repair or replace the product, the product will be covered for the remainder of the original warranty period. We reserve the right to repair or replace refurbished equipment, products or accessories which may involve the use of the same functions.
7. Consumable parts, such as batteries, are not covered by the warranty.
8. The manufacturer reserves the right to change and interpret these terms and conditions of the warranty at its own discretion.

Grepow Inc.  
290 Lindbergh Ave  
Livermore, CA 94551  
United State

Genspow GmbH  
Ottostr.11  
41352 Korschenbroich  
Germany

[service@lokithor.net](mailto:service@lokithor.net)

[WWW.LOKITHOR.NET](http://WWW.LOKITHOR.NET)

